

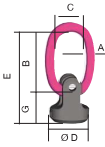

**WPPH-B** Weld-on eye connection  
(non-swivelling)



Type	WLL (kgs)	A (mm)	B (mm)	C (mm)	D (mm)	E (mm)	G (mm)	Weight (kgs)
WPPH-B-0.6 <sup>3t</sup>	6 <sup>30</sup>	9	65	35	34	99	34	0.3
WPPH-B-1.5t	1500	11	65	35	40	109	44	0.5
WPPH-B-2.5t	2500	13	74	40	5 <sup>3</sup>	127	5 <sup>3</sup>	0.9
WPPH-B-4t	4000	16	95	45	68	16 <sup>3</sup>	67	2.2
WPPH-B-5t	5000	21	130	60	8 <sup>3</sup>	209	79	4.5
WPPH-B-8t	8000	24	140	65	88	228	88	5.1

**WPPH-S** Weld-on universal connection  
(non-swivelling)

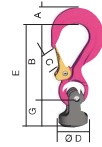

Type	WLL (kgs)	A (mm)	B (mm)	C (mm)	D (mm)	E (mm)	G (mm)	Weight (kgs)
WPPH-S-0.6 <sup>3t</sup>	6 <sup>30</sup>	13	75	18	34	109	34	0.35
WPPH-S-1.5t	1500	20	97	25	14 <sup>1</sup>	44	44	0.95
WPPH-S-2.5t	2500	28	126	30	5 <sup>3</sup>	179	5 <sup>3</sup>	1.4
WPPH-S-4t	4000	36	150	35	68	217	67	3.2
WPPH-S-5t	5000	37	174	40	8 <sup>3</sup>	253	79	6.9
WPPH-S-8t	8000	49	208	48	88	296	88	8.0

**VABH-W** Weld-on excavator hook

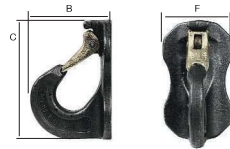

Type	WLL (kgs)	B (mm)	C (mm)	F (mm)	Weight (kgs)
VABH-W 1.5t	1500	78	117	70	0.8
VABH-W 2.5t	2500	101	148	85	1.8
VABH-W 4t	4000	122	171	104	3.1
VABH-W 6.7t	6700	156	208	120	5.9

**VCGH-S** High capacity  
weld-on excavator hook

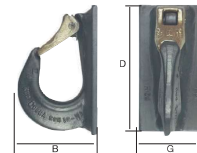

Type	WLL (kgs)	B (mm)	C (mm)	F (mm)	Weight (kgs)
VCGH-S 16	10000	141	220	100	5.0
VCGH-S 20	16000	187	288	120	8.4
VCGH-S 22	20000	195	292	120	14.5

**VWBG-V** Bolt on swivel ring bolt  
360° swivelling, 180° pivoting



Type	WLL (kgs)	A (mm)	C (mm)	F* (mm)	Weight (kgs)
VWBG-V-0.3 M8	300	8	29	13	0.18
VWBG-V-0.45 M10	450	8	29	17	0.29
VWBG-V-0.6 M12	600	10	35	21	0.41
VWBG-V-1.3 M16	1300	13	38	25	0.59
VWBG-V-2.0 M20	2000	13	35	33	1.42
VWBG-V-3.5 M24	3500	18	40	40	2.63
VWBG-V-5.0 M30	5000	22	50	50	5.09

**VWBG** Bolt on swivel ring bolt 360° swivelling,  
180° pivoting, with ball bearing



Type	WLL (kgs)	A (mm)	C (mm)	F (mm)	Weight (kgs)
VWBG-8 M26	8000	22	50	54	4.67
VWBG-12 M42	12000	26	65	63	6.1
VWBG-13 M48	13000	26	65	68	6.37
VWBG-16 M56	16000	32	70	84	11.2
VWBG-16 M64	16000	32	70	96	11.4
VWBG-40 M90	40000	40	80	135	33.16

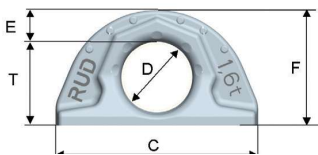

- Manufactured in Germany using high tensile CrNiMo - steel
- 100% Electro-magnetic crack detection tested
- Complies with DIN 5691 and EN 1677
- 4 :1 Safety factor on Working Load Limit
- Temperature Range -40°C to 100°C no reduction in WLL
- Full working load in all directions
- Patented wear markings on the inside and on the outside

Type	WLL (kgs)	A (mm)	B (mm)	C (mm)	D (mm)	E (mm)	F (mm)	T (mm)	Weight (kgs)
ABA 1.6	1600	30	16	100	35	16	57	41.5	.44
ABA 3.2	3200	41	23	137	50	21	80	59	1.1
ABA 5	5000	51	27	172	60	27.5	99	71.5	2.3
ABA 10	10000	70	38	228	80	35	120	95	5.3
ABA 20	20000	90	52	272	115	40	175	135	10.7
ABA 31.5	31500	108	64	320	130	50	204	154	18.3